



Above Ground Pool Quick Reference Guide



Welcome

Welcome to the Pool and Spa Depot family! The following guide is to help you understand what is involved in building your new above ground pool.

Your above ground pool installation will require the following input from you:

1. To mark the desired location of the pool and equipment
2. To order the necessary sand for the size of your pool
3. To check with your local codes office for permits and other requirements

Like any outdoor construction project, unforeseen circumstances may occur (weather, scheduling, ground conditions, etc.).

Our service department will reach out to you and schedule a day that is convenient for your installation within days of your finalized purchase.

If you have any questions, at any point in the process, please reach out to your local store's service department:

Coolsprings - Brentwood, TN (615) 315 8000

Bowling Green, KY (270) 782 1119

Cookeville, TN (931) 854 9255

Clarksville, TN (931) 919 5025

Service Department (615) 514-1911

Email: Service@Poolandspadepot.com



Before Installation Checklist

- ☐ **Underground Lines:** Locate and clearly mark electric, phone, cable, or any other utility lines, septic tank, and field lines on or near pool site prior to excavation.
- ☐ **Permits:** Check with local, county, and state codes departments and provide any permits required to issue complete compliance with all code ordinances.
- ☐ **Pool plus Pump & Filter Location:** Locate and mark the pool site and filter location prior to excavation and in accordance with all state and local codes.
- ☐ **Find our Access:** Provide an 8' access path for excavation equipment. Pool and Spa Depot will not be responsible for damage to the yard, driveway, or any obstacles in access path.
- ☐ **Sand Material:** Order and pay for fine mason sand, and arrange for delivery. Sand is to be placed within 20' of pool site, but not directly on the area to be excavated.

Reference: Laying Out Your Pool on next page.

Sand Requirement:

POOL SIZE	SAND TO ORDER	POOL SIZE	SAND TO ORDER
15' Pool	4 tons of sand	27' Pool	9 tons of sand
18' Pool	5 tons of sand	30' Pool	10 tons of sand
21' Pool	6 tons of sand	33' Pool	12 tons of sand
24' Pool	7 tons of sand	15'x 30' Pool	10 tons of sand
10' x 20' Pool	5 tons of sand	18'x 33' Pool	12 tons of sand
12' x 23' Pool	6 tons of sand		

After Installation Checklist

- ☐ **Fill Pool:** Furnish water and fill the pool to the proper level (approximately 1/2 way up the skimmer opening) before starting filter system. See "Filling Instructions."
- ☐ **Install Steps:** Placement of steps (if purchased) into the pool after filling with water. (Note: we DO NOT install the steps during installation. We will leave the steps a few feet away from the pool) this is the homeowner responsibility to put the steps in the water.
- ☐ **Grading Services:** Grade, Remove, Spread, and/or backfill any excess dirt or sand left around the pool. (Note: We DO NOT provide grading or haul off services in our installation) this is the homeowner responsibility.
- ☐ **Extra Services:** Pay for any excavation beyond what is included. Requests for additional work must be made prior to installation. Payment is to be made to the excavator.
- ☐ **Pool Safety:** Teach pool safety to family and guests, specifically NO DIVING, SHOIVING, PUSHING, or HORSE PLAY. Install and use alarms and all other safety devices ensuring compliance with all safety regulations.

Note: POOL AND SPA DEPOT IS NOT RESPONSIBLE FOR WATER REPLACEMENT FOR ANY REASON.

Electrical Requirements

The customer must provide a 20 amp 110v power source for the filter that is protected by a Ground Fault Circuit Interrupter (G.F.C.I.). This service should be provided by a qualified electrician in accordance with state and local codes after the pool has been installed. This specifically includes a pool alarm, as required by Tennessee State Codes.

Note: An extension cord does not meet electrical codes and will void the pump manufacturers warranty.

You will need to schedule your electrical the DAY OF or AFTER the pool is installed, not before.



Laying Out Your Pool

To begin, make sure that the pool site is not within 15' of any overhead power lines, and 10' from any trees. The pool cannot be built over any part of a septic system, and you are responsible for making sure the pool is not infringing on any property lines, easements, or built over any utility lines.

Note: Required distances from property lines vary in every community. Most of this information can be obtained when you get your permit.

Round Pools: Once you have chosen your site, place a screwdriver into the ground at the center of the pool. Secondly, measure a section of string that is half of the diameter of your pool, plus an extra 2'. For example, a 24' pool would require a 14' string. The extra 2' is for the over dig of the pool site. We will need to have a minimum of 2' around the pool to have the room for proper installation. Next, tie one end of the string to the screwdriver, and while pulling the string tight, walk the circumference of the pool and mark it with several stakes or paint.

Oval Pools: Oval pools are done in about the same manner. Keep in mind that due to the side braces on an oval pool, the "overdig" requires the dimensions of the pool, plus 2' on the width and 5' on the length. For example, an 18' x 33' oval would be staked out at 28' x 37'. Stake out or paint the area as best you can, and the installer will verify and square up the site for you.

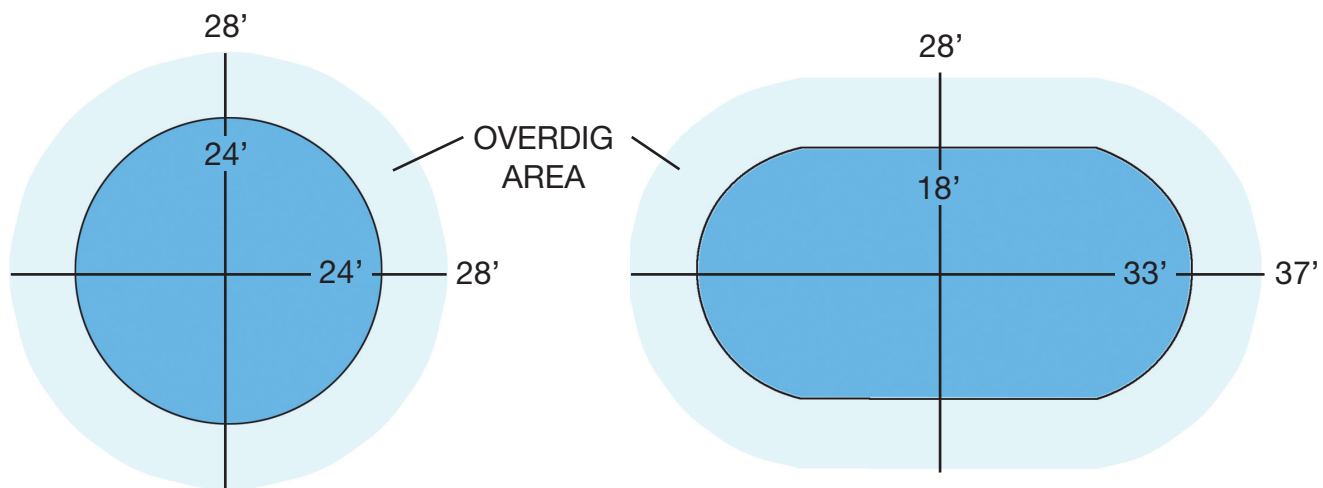

So remember these key questions:

- Approximately how far out of level is the pool site (Inches)?
- Are there overhead power lines near the pool site?
- Are there underground utilities?
- Are there any trees or tree stumps near the pool site?
- Do you have a septic system?

Installation Photos

Most homeowners would like to know what their project will look like after installation. Below are some great photos of our installation and what to expect after the project is completed.



This is left over pool sand on the job site. It is more cost saving to order more sand and have a little left over than to order and pay another delivery charge if you don't have enough.



This pool had a very small slope, but you can see how much dirt is left behind. Additional excavation, grading and dirt work beyond that which is required for leveling the pool site is available by bid only.



Some jobs have a little rock in the ground when we dig, so be aware that your yard could have the same. It is important for the bottom of the pool base around the outside to have dirt pushed up around it to help contain the sand.



This picture shows where a homeowner asked us to move the dirt to the end of his property. This can be done by paying the excavator directly after the pool is installed. A local bobcat operator can be found to move dirt and grade your yard after the build for an affordable rate.



This is a picture of your pump and filter. Notice the dirt ground after digging out the pool. This is very common, and most homeowners plant seed and straw to grow back the grass after installation, or you can use decorative gravel.

Installation with an Existing Deck

If you have an existing deck around your pool, we can still install a new pool. The illustration below shows what your new pool will look like if your pool size is different and also the up to 24" inch gap that may be left when installing the same size pool. Even when replacing an identical size pool, difference in manufacturers and pool models often vary slightly in dimensions or number of uprights. This can result in the need for a carpenter to modify your deck before or after the installation.



Note: Due to varying conditions involving pool installations beside pre-existing decks, Pool and Spa Depot and/or their installers will not be responsible for precise pool placement, elevation, or joining of pools beside pre-existing decks.

The Pool and Spa Depot installers will attempt to place pool as close as possible to pre-existing deck, but a gap of up to 24 inches may occur. Pool and Spa Depot and their installers are not responsible for any gap up to the 24-inch range.

The Biltmor by Innovaplas

The placement of steps (if purchased) into the pool after filling with water is your responsibility. (Note: we DO NOT install the steps during installation.) We will leave the steps a few feet away from the pool. The reason for this is you have to wait until the pool is 100% filled, before putting the steps in the pool. Since the homeowner will fill the pool, this is their responsibility to put the steps in the water.

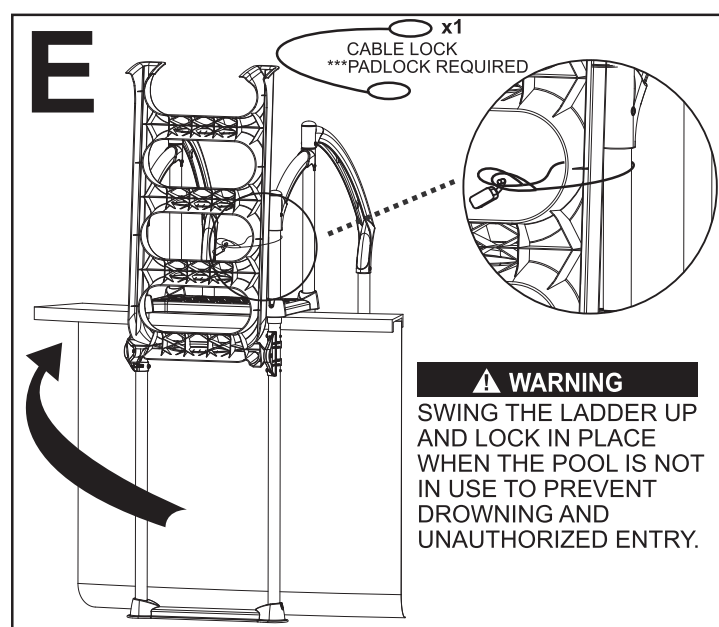
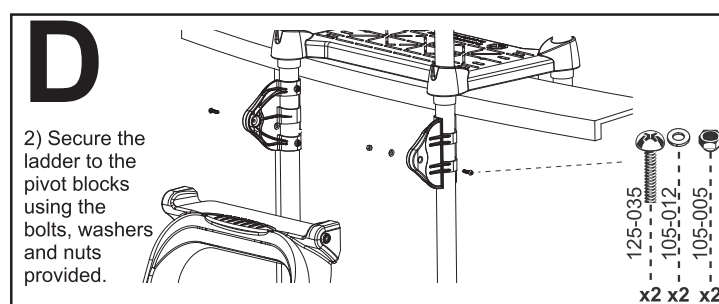
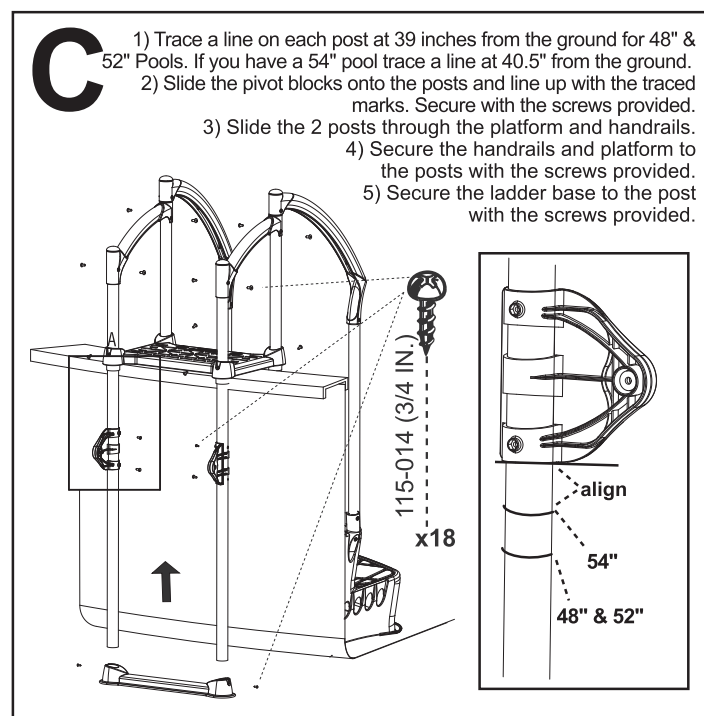
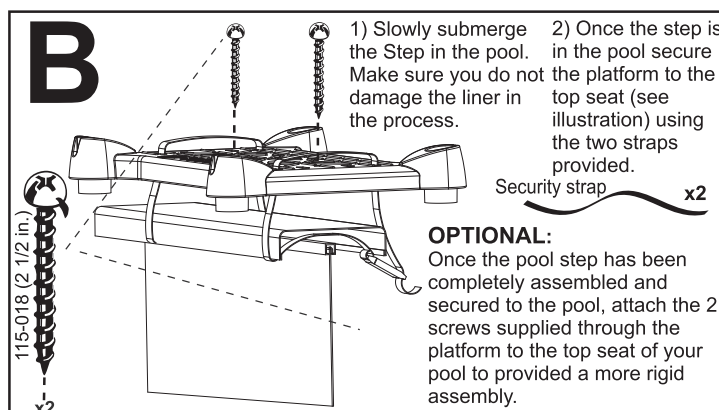
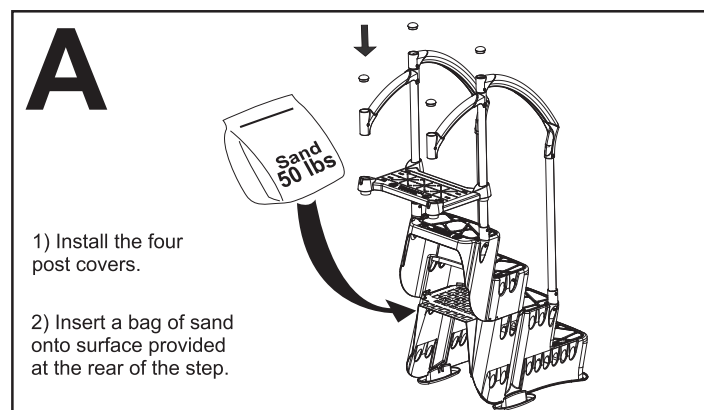

Filling Instructions

Pool liners are designed to stretch slightly as they fit the pool during filling. Weather conditions and air temperature directly affect the pace in which the filling can be completed. If the pool is filled at night, or too quickly during the day without sunlight reaching the pool, the liner can buckle the wall or pull down causing a sag in the wall pattern. These are not usually structural problems. However, they are unattractive. The installation guarantee does not cover the liner sags or wall buckles caused by improper filling. We have included detailed suggestions below to help prevent these issues from happening.

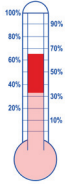

32-65 Degree Filling:

During the final stages of installation, the installers will begin to fill the pool to seat the liner. They will remove any folds from the packaging and position the liner evenly around the wall and floor. After the installers have left, continue filling the pool until you reach a total of 6 inches. Please do not continue to fill the remainder of the pool for the rest of the day. The following days if weather allows, begin to add 2 to 3 inches of water each day.

Special Instructions:

- A. Only add water on days that direct sunlight is reaching the pool.
- B. Do not add more than 3 inches unless the water is 65 degrees. If it is above 65 degrees and direct sunlight is reaching the pool, do not add more than 6 inches.
- C. Continue this process until you reach a total of 24 inches. After 24 inches you may fill the remainder of the pool. Only add water on the days that have direct sunlight reaching the pool.

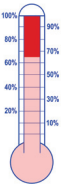

65 Degrees & Warmer Filling:

During the final stages of installation, the installers will begin to fill the pool to seat the liner. They will remove the folds from the packaging and position the liner evenly around the wall and floor. After the installers have left, continue filling the pool until direct sunlight is no longer reaching the pool. Please DO NOT continue to fill the pool for the remainder of the day. The following day (if the sun allows), begin to add water as direct sunlight is reaching the pool each day.

Special Instructions:

- A. Only add water on days that have direct sunlight reaching the pool.
- B. If the temperature is above 65 degrees and direct sunlight is reaching the pool, you may continue filling the pool until direct sunlight is no longer reaching the pool.
- C. Continue this process until you reach a total of 24 inches. After reaching 24 inches, you may fill the remainder of the pool.

Other Important Information:

Pool & Spa Depot does NOT recommend 'Quick Filling' methods such as water tanker, fire hydrant and/or multiple hose use. If these methods are the only source of filling available, please do not attempt to fill the pool unless the temp is above 75 degrees and direct sunlight is reaching the pool. Also, please request the lowest level of water pressure is used during the filling.

DO NOT ENTER THE POOL AND/OR STAND ON THE LADDER/STEP SYSTEM BEFORE THE POOL IS COMPLETELY FULL OR THE SAND BOTTOM WILL BE COMPROMISED. (I.E. FOOTPRINTS, HEEL INDENTIONS, ETC.). THE INSTALLATION GUARANTEE DOES NOT COVER THESE OCCURRENCES.

LINER DAMAGE CAUSED BY NUTGRASS, INSECTS, NEGLECT OR ACTS OF GOD ARE NOT COVERED UNDER ANY WARRANTY.

**YOU ARE NOW READY TO ENJOY THE SUMMER IN
THE SAFETY AND COMFORT OF YOUR VERY OWN POOL!**



On behalf of everyone at Pool and Spa Depot, we would like to take a moment to thank you for choosing us to be your swimming pool installer. The building of an above ground swimming pool can be an exciting and quick process.

For any future service or operational needs, contact our Service Department:

Coolsprings - Brentwood, TN (615) 315 8000

Bowling Green, KY (270) 782 1119

Cookeville, TN (931) 854 9255

Clarksville, TN (931) 919 5025

Service Department (615) 514-1911

Email: Service@Poolandspadepot.com



Thank you for choosing Pool & Spa Depot



NASHVILLE

(CoolSprings)
7115 Bakers Bridge Ave.
Brentwood, TN 37027
615-315-8000



CLARKSVILLE

160 Terminal Rd.
Clarksville, TN 37040
931-919-5025



COOKEVILLE

1470 Interstate Dr.
Cookeville, TN 38501
931-854-9255



BOWLING GREEN

1830 Wallace Ct.
Bowling Green, KY 42103
270-782-1119



HEADQUARTERS

165 Stones River Rd.
La Vergne, TN 37086
615-514-1911



SIGNUP NOW TO GET A FREE VIP CARD 10% OFF

FREE VIP CARD GOOD FOR FUTURE CHEMICAL PURCHASES

FOR 12 MONTHS

NAME:

PHONE:

ADDRESS:

EMAIL:

CITY:

ZIP CODE:



START SAVING TODAY!





POOL SCHOOL!

We would like to invite you to our FREE Pool School held every Saturday morning at 9:00 a.m. during the pool season. We discuss chemicals, filter systems, vacuuming, and how to maintain your pool.

Call your local Pool & Spa Depot to confirm availability, class times and reserve your seat.

For any future service or operational needs, contact our Service Department:

Coolsprings - Brentwood, TN (615) 315 8000
Bowling Green, KY (270) 782 1119
Cookeville, TN (931) 854 9255
Clarksville, TN (931) 919 5025
Service Department (615) 514-1911

Email: Service@Poolandspadepot.com

Be sure to bring us a fresh water sample from your pool and we'll test it while you're here!

We also offer a FREE Winter Closing School in fall, call your local Pool & Spa Depot for details.

HEADQUARTERS



Stones River Road
La Vergne, TN 37086
615-514-1911

NASHVILLE

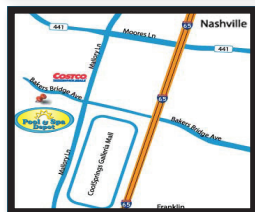

(CoolSprings)
7115 Bakers Bridge Ave.
Brentwood, TN 37027
615-315-8000

CLARKSVILLE



160 Terminal Road
Clarksville, TN 37040
931-919-5025

BOWLING GREEN

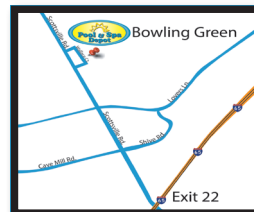

1830 Wallace Ct.
Bowling Green, KY 42103
270-782-1119

COOKEVILLE



1470 Interstate Dr.
Cookeville, TN 38501
931-854-9255

